

POST-COVID19

How We Can Help

Preparing for a New Normal

Buildings will face new challenges as they re-open to their employees, students, and the public. How can we re-calibrate our spaces for new health concerns and requirements?

Although this time is unprecedented, our role is no different. As architects, engineers, and interior designers, it is our forte to problem-solve. We are actively advising clients on re-tooling buildings to address these concerns, both comprehensive and subtle. Whether your organization knows your exact needs or not, we can help.

This sheet serves as a conversation starter and as a lens for re-examining projects. It can spark new considerations, such as circulating spaces safely or environmental impacts of building modifications.



Building Entry Sequence & Control



Touchless Controls

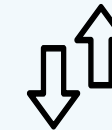

Traffic Flow & Circulation Analysis

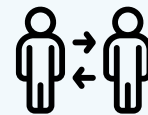

Floor Plan Distancing Diagrams

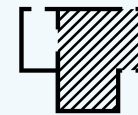

Space Analysis Repurposing & Adaptation



Technology for Virtual Connectivity



Furniture & Finish Assessment & Recommendations



Facilities Operations Assessment

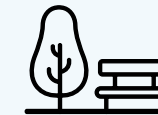

Exterior Space Design



HVAC System Assessment & Recommendations

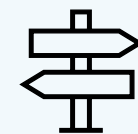

Environmental Graphics & Signage



Healthy Building Assessment

Our Specialists



WORKPLACE

Tracy Sciano Vajskop NCIDQ, IIDA, LEED AP ID+C
Associate Principal | Senior Interior Designer

P (216) 767-2014
E tvajskop@bialosky.com



EDUCATION

Christy Schalmo AIA, NCIDQ
Associate | Architect & Interior Designer

P (216) 767-2059
E cschalmo@bialosky.com

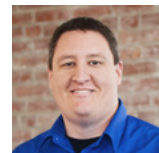

HVAC / MECHANICAL

Mike Huston PE, LEED AP BD+C, LEED ID+C
Senior Associate | Senior Mechanical Engineer

P (216) 767-2093
E mhuston@bialosky.com

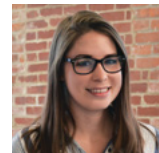

EDUCATION

Sam Meyer LEED AP ID+C
Interior Designer

P (216) 767-2025
E smeyer@bialosky.com



LIBRARY

Ben Crabtree AIA, LEED AP
Senior Associate | Architect

P (216) 767-2021
E bcrabtree@bialosky.com



MULTIFAMILY & STUDENT HOUSING

Seth Duke AIA
Architect

P (216) 767-2002
E sduke@bialosky.com



SUSTAINABILITY

John Guzik RA, LEED AP
Senior Associate | Architect

P (216) 767-2011
E jguzik@bialosky.com



HEALTHY BUILDING

Kate Walker WELL AP, LEED GA, FITWEL AMB.
Interior Designer

P (216) 767-2027
E kwalker@bialosky.com